



## FERBOX® Type E02

Rebend connection, angled hooks perpendicular to the box

FERBOX® Type E02 single-row rebend connections are used for the frictional connection and reinforcement of reinforced concrete parts. They are suitable for narrow walls from 100 mm wall thick. They have the highest joint category – Interlocked – in transverse and longitudinal directions.. Their studded reinforcement box and cover are made of galvanised sheet metal and the reinforcing bars are made of B500 B or stainless steel. The bars have an L-shape parallel to the box for the first casting section. The FERBOX® box is either 800 or 1200 mm long and 60 to 135 mm wide. The standard diameter of the rods is 8 to 10 mm. Other versions and special solutions are available on request.



Products		weight
512300022051	Ferb E02 60 08 150 1.20	2,304 kg
512300022052	Ferb E02 60 08 200 1.20	2,016 kg
512300022053	Ferb E02 60 08 250 1.20	1,728 kg
512300022055	Ferb E02 60 10 150 1.20	3,552 kg
512300022056	Ferb E02 60 10 200 1.20	2,880 kg
512300022057	Ferb E02 60 10 250 1.20	2,760 kg
512300022050	Ferb E02 85 08 100 1.20	3,480 kg
512300022054	Ferb E02 85 10 100 1.20	5,076 kg
512300022058	Ferb E02 85 12 100 1.20	7,776 kg
512300022059	Ferb E02 85 12 150 1.20	5,568 kg
512300022060	Ferb E02 85 12 200 1.20	4,128 kg
512300022061	Ferb E02 85 12 250 1.20	4,560 kg

## DETAIL AND APPLICATION IMAGES



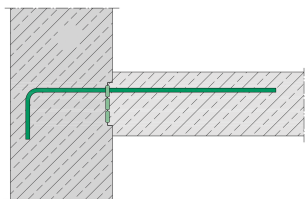

ETA

, ETA-20/0842

