



Single outlet made of stainless steel

Information



System overview
Installation units for screed and hollow floors

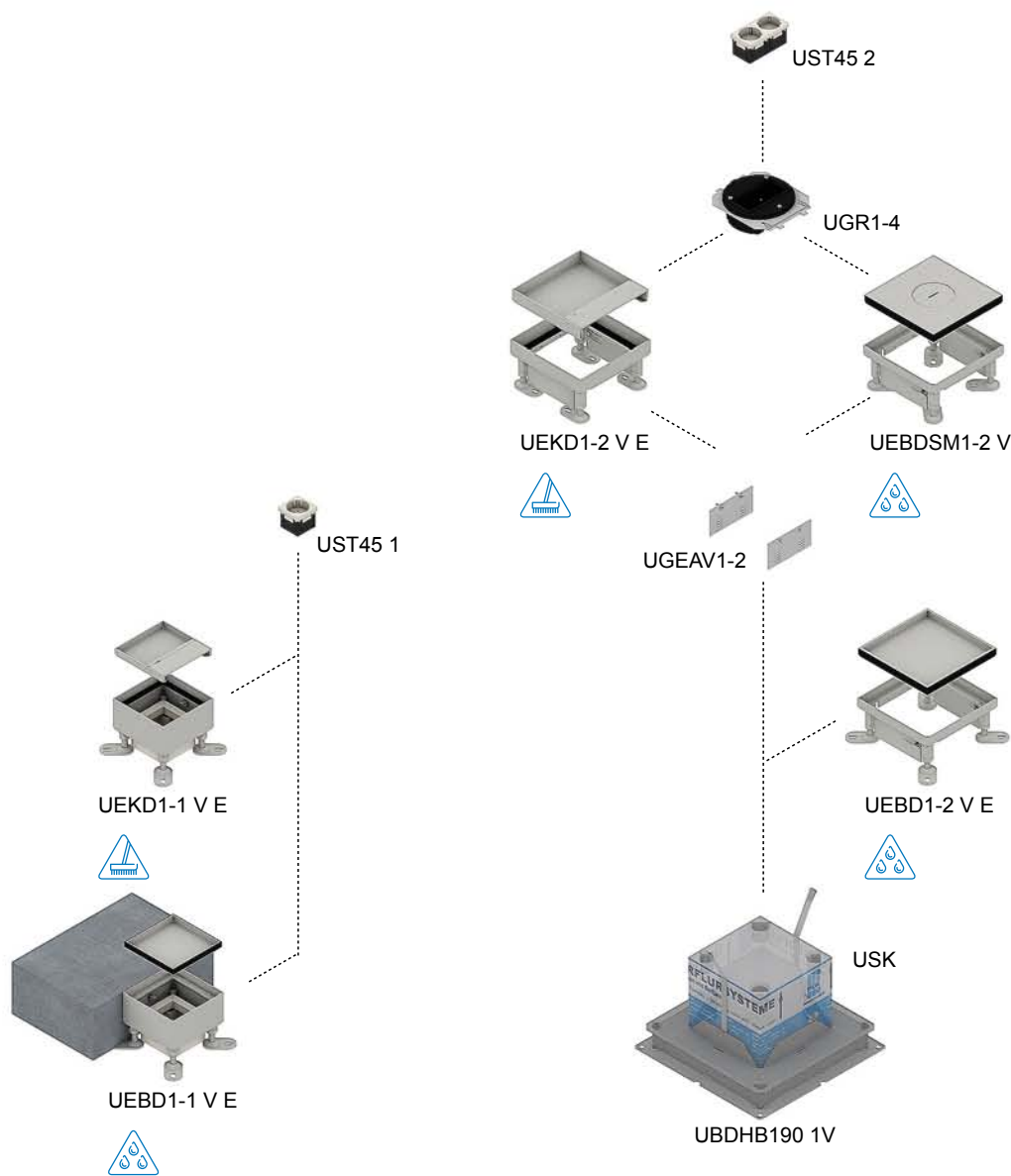

Single outlet made of stainless steel

Information

UEBD1-1 V E Dummy single-outlet cartridge, quadrangular, levellable

Square dummy single outlet cartridge for direct screed installation made of stainless steel sheet with hem to accommodate one 45x45 mm installation device for rooms with wet-maintenance floor covers.

| article number | H _{min} mm | N mm | B mm | L mm | E mm | T mm | P _{max} kN | IP _n | G kg |
|-----------------------|------------------------|---------|---------|---------|-----------|---------|------------------------|-----------------|---------|
| E G | | | | | | | | | |
| UEBD1-1 15-V E | 100 | + 40 | 115 | 115 | 115 x 115 | 12 | 2 | IP 54 | 2,20 |

accessories included:

1 x **UGD1-1-V 2** rubber seal, quadrangular (page C53)
1 x **UEBD1-G45** Body single outlet (page C53)

accessories optional:

UST45 1 shockproof socket single (page D30)
UDAE22 data systems installation device single (page D34)

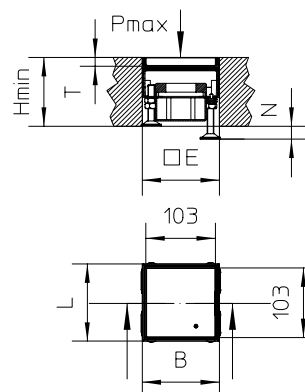
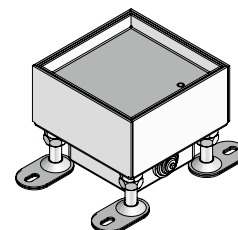

UEKD1-1 V E Single-outlet cable cartridge, one-piece, quadrangular, levellable

Square cable single outlet cartridge for direct screed installation, made of stainless steel, with hem, to accommodate one 45x45mm installation device, for rooms with dry maintenance floor covers.

| article number | H _{min} mm | N mm | B mm | L mm | E mm | T mm | P _{max} kN | IP _n | IP _g | G kg |
|-----------------------|------------------------|---------|---------|---------|-----------|---------|------------------------|-----------------|-----------------|---------|
| E G | | | | | | | | | | |
| UEKD1-1 15-V E | 100 | + 40 | 115 | 115 | 115 x 115 | 12 | 2 | IP 30 | IP 20 | 1,70 |

accessories included:

1 x **UGD1-1-V 2** rubber seal, quadrangular (page C53)
1 x **UEKD1-1-G45** Body single outlet (page C53)

accessories optional:

UST45 1 shockproof socket single (page D30)
UDAE22 data systems installation device single (page D34)

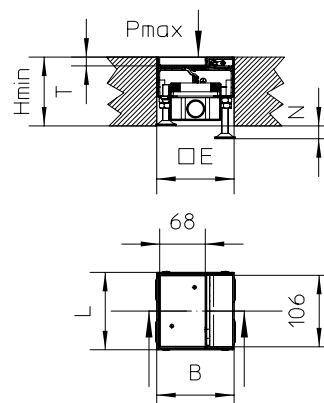
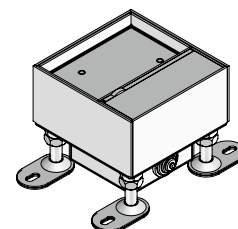

Single outlet made of stainless steel

Information

UEBD1-2 V E Dummy single-outlet cartridge, quadrangular, levellable

Square dummy single outlet cartridge made of stainless steel sheet as an inspection chamber with hem for rooms with wet-maintenance floor covers.

| article number | H mm | H _{min} mm | N mm | B mm | L mm | E mm | T mm | P _{max} kN | IP _n | G kg |
|-----------------------|---------|------------------------|---------|---------|---------|-----------|---------|------------------------|-----------------|---------|
| E G | | | | | | | | | | |
| UEBD1-2 15-V E | 19 | 80 | + 45 | 160 | 160 | 164 x 164 | 12 | 2 | IP 54 | 1,80 |
| UEBD1-2 25-V E | 29 | 90 | + 45 | 160 | 160 | 164 x 164 | 22 | 2 | IP 54 | 1,90 |

accessories included:

1 x **UGKD1-2-V 2** rubber seal, quadrangular

accessories optional:

UGEAV1-2 set of registering leads, quadrangular

UGR1-4 Device cup, round, pre-assembled

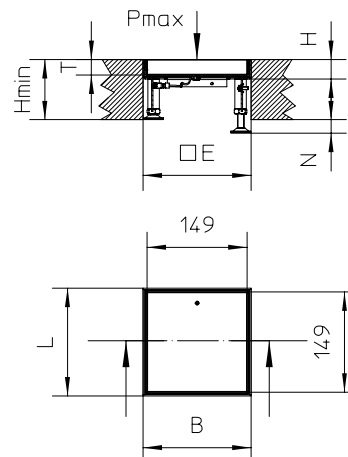
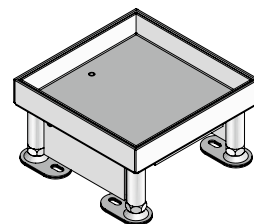

UEKD1-2 V E Single-outlet cable cartridge, quadrangular, levellable

Angular single cable outlet cartridge made of high-grade sheet steel with abutting edge for one device cup for the installation of two 45x45 mm installation devices, for rooms with dry maintenance floor covers.

| article number | H mm | H _{min} mm | N mm | B mm | L mm | E mm | T mm | P _{max} kN | IP _n | IP _g | G kg |
|-----------------------|---------|------------------------|---------|---------|---------|-----------|---------|------------------------|-----------------|-----------------|---------|
| E G | | | | | | | | | | | |
| UEKD1-2 15-V E | 19 | 80 | + 45 | 160 | 160 | 164 x 164 | 12 | 2 | IP 30 | IP 20 | 1,12 |
| UEKD1-2 25-V E | 29 | 90 | + 45 | 160 | 160 | 164 x 164 | 22 | 2 | IP 30 | IP 20 | 1,30 |

MS | G

| | | | | | | | | | | | |
|------------------------|----|----|------|-----|-----|-----------|----|---|-------|-------|------|
| UEKD1-2 25-V MS | 29 | 90 | + 45 | 160 | 160 | 164 x 164 | 22 | 2 | IP 30 | IP 20 | 1,30 |
|------------------------|----|----|------|-----|-----|-----------|----|---|-------|-------|------|

accessories included:

1 x **UGKD1-2-V 2** rubber seal, quadrangular

accessories optional:

UGEAV1-2 set of registering leads, quadrangular

UGR1-4 Device cup, round, pre-assembled

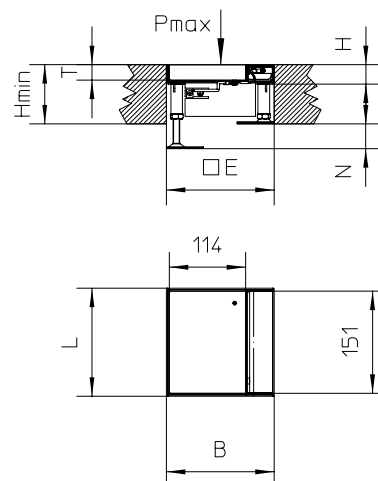
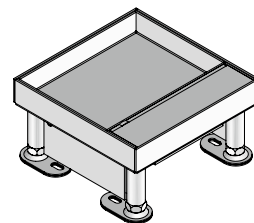

Single outlet made of stainless steel

Information

UEBDSM1-2 V heavy-duty tube single outlet cartridge, quadrangular, levellable

Angular heavy-duty tube single cable outlet cartridge made of high-grade sheet steel with abutting edge for one device cup for the installation of two 45x45 mm installation devices, for rooms with wet maintenance floor covers.



| article number | H mm | H _{min} mm | N mm | B mm | L mm | E mm | P _{max} kN | IP _n | IP _g | G kg |
|---------------------------|---------|------------------------|---------|---------|---------|-----------|------------------------|-----------------|-----------------|---------|
| E G | | | | | | | | | | |
| UEBDSM1-2 15-V8-WD | 19 | 80 | + 45 | 160 | 160 | 164 x 164 | 20 | IP 54 | IP 22 | 4,39 |

accessories included:

1 x **UGKD1-2-V 2** rubber seal, quadrangular
1 x **UETD-R-WD** tube cover

accessories optional:

UGEAV1-2 set of registering leads, quadrangular
UGR1-4 Device cup, round, pre-assembled
UET tube for wet maintenance

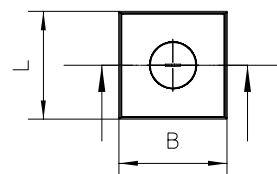
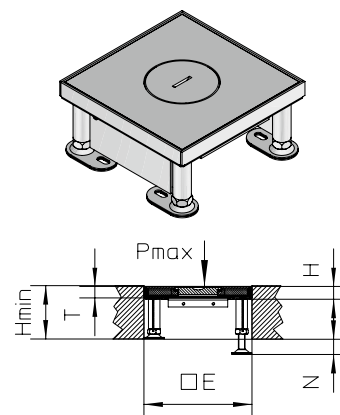

UGEAV1-2 set of registering leads, quadrangular

To be screwed to a single outlet.

| article number | H mm | B mm | G kg |
|---------------------|---------|---------|---------|
| S | | | |
| UGEAV1-2 50S | 59 | 98 | 0,13 |

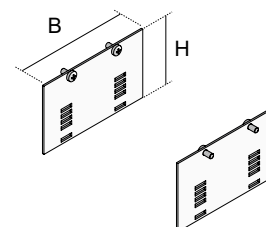

UGR1-4 Device cup, round, pre-assembled

For the insertion of two 45x45 mm installation devices.

| article number | H _{min} mm | B mm | L mm | t mm | G kg |
|----------------|------------------------|---------|---------|---------|---------|
| S | | | | | |
| UGR1-4 | 70 | 128 | 125 | 2 | 0,30 |

accessories optional:

UG R device installation cup, round

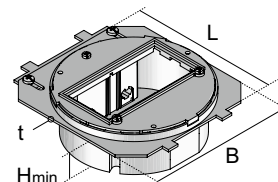

Single outlet made of stainless steel | Accessories

Information

UGD1-1 V rubber seal, quadrangular

| article number | B mm | L mm | t mm | G kg |
|-------------------|---------|---------|---------|---------|
| G | | | | |
| UGD1-1-V 2 | 110 | 110 | 2 | 0,01 |

accessories optional:

UEBD1-1 V E Dummy single-outlet cartridge, quadrangular, levellable

UEKD1-1 V E Single-outlet cable cartridge, one-piece, quadrangular, levellable

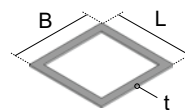

UGKD1-2 V 2 rubber seal, quadrangular

| article number | B mm | L mm | t mm | G kg |
|--------------------|---------|---------|---------|---------|
| G | | | | |
| UGKD1-2-V 2 | 119 | 119 | 2 | 0,01 |

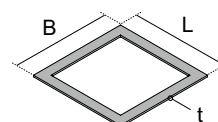

UEBD1 G45 Body single outlet

For the insertion of one 45x45 mm installation device.

| article number | H mm | B mm | L mm | E mm | colour | G kg |
|------------------|---------|---------|---------|---------|-------------------------------|---------|
| UEBD1-G45 | 63 | 75,5 | 75,5 | 45 x 45 | light grey (similar RAL 7035) | 0,09 |

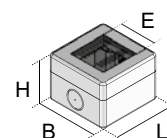

UEKD1-1 G45 Body single outlet

For the insertion of one 45x45 mm installation device.

| article number | H mm | B mm | L mm | E mm | colour | G kg |
|--------------------|---------|---------|---------|---------|-------------------------------|---------|
| UEKD1-1-G45 | 53 | 75,5 | 75,5 | 45 x 45 | light grey (similar RAL 7035) | 0,09 |

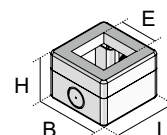

Single outlet made of stainless steel | Accessories

Information

UBDHB190 1V Hollow space floor box single, quadrangular

Hollow space floor box with an installation opening of 164x164mm for quadrangular single outlets.

| article number | H mm | H _{min} mm | B1 mm | B2 mm | L1 mm | L2 mm | E mm | G kg |
|-------------------------|---------|------------------------|----------|----------|----------|----------|---------|---------|
| S | | | | | | | | |
| UBDHB190 28-160V | 31 | 67 | 270 | 290 | 270 | 290 | 165 | 1,20 |
| UBDHB190 38-160V | 41 | 77 | 270 | 290 | 270 | 290 | 165 | 1,90 |
| UBDHB190 48-160V | 51 | 87 | 270 | 290 | 270 | 290 | 165 | 2,00 |

accessories included:
1 x **UBDHB-Z** grounding clamp

accessories optional:
UN nail plug
USK shuttering unit quadrangular

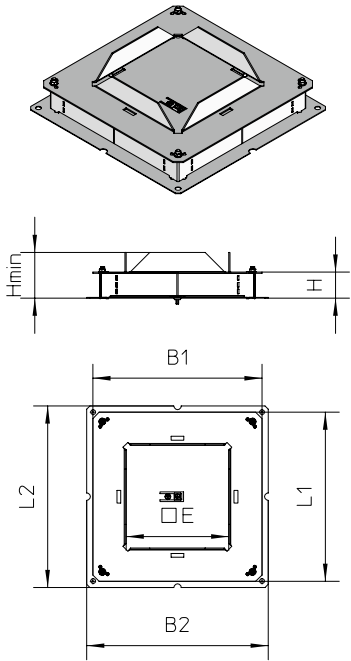

USK shuttering unit quadrangular

Polystyrene shuttering unit for the construction of an installation opening for quadrangular installation units. To be used in a hollow space floor box.
Caution: insulating strip of max. thickness of 2 mm!

| article number | H mm | B mm | L mm | E mm | G kg |
|---------------------|---------|---------|---------|---------|---------|
| STY | | | | | |
| USK 259V-225 | 225 | 262 | 262 | 262x262 | 0,24 |
| USK 259V-150 | 150 | 262 | 262 | 262x262 | 0,19 |
| USK 185V-150 | 150 | 262 | 186 | 187x262 | 0,16 |
| USK 160V-150 | 150 | 163 | 163 | 165x165 | 0,08 |

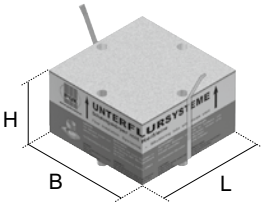

Single outlet, quadrangular | Direct mounting in screed

Assembly instruction

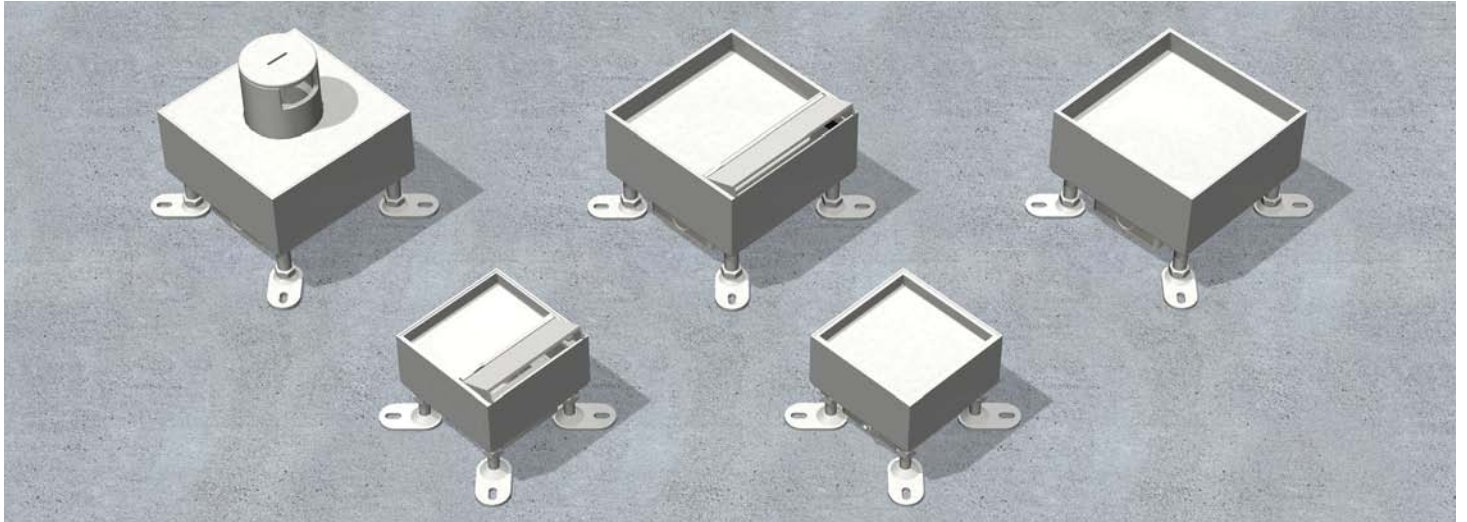

Quadrangular single outlets with outer measurements of 115 x 115 mm for the integration of up to two installation devices of 45 x 45 mm for direct screed mounting.

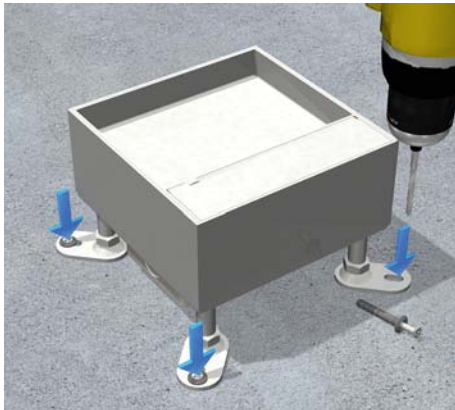

1 | Fixating
Mount the four levelling legs onto the rough concrete ceiling with nail plugs.

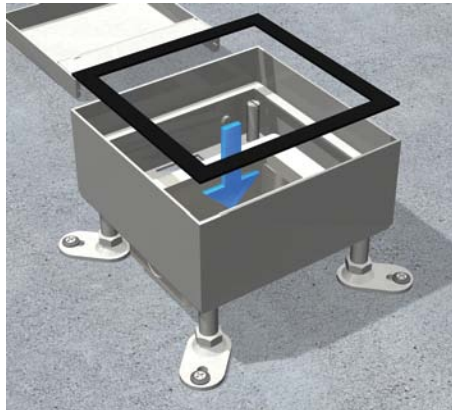

2 | Rubber sealing
Remove the lid and glue the rubber in place.



3 | Cable entry
For the cable entry use a tool to break the lateral perforation out of the frame and complete with strain relief.

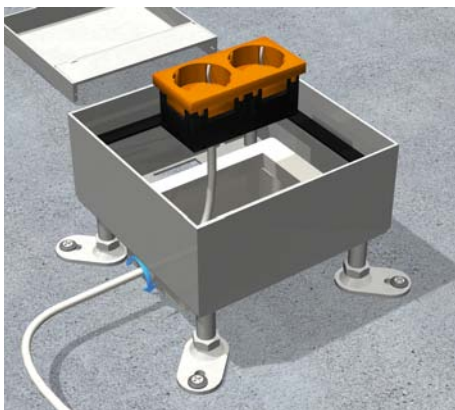

4 | Safety sockets
Install electrical sockets and fuse strain relief.



5 | Assembly
Latch the sockets into the frame. Factor the single outlet into the potential equalization.

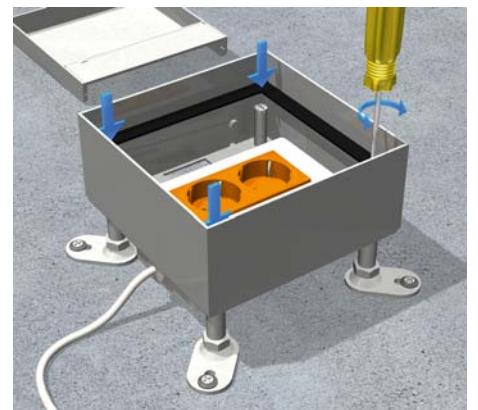

6 | Floor adjustment
Place the single outlet abreast finished floor level flush with the four levelling screws. Screed can now be applied.

Single outlet, quadrangular | Hollow space floor box

Assembly instruction



Quadrangular single outlets with external dimension of 160 x 160 mm for the integration of up to two installation devices of 45 x 45 mm for fixture in hollow space floor boxes.

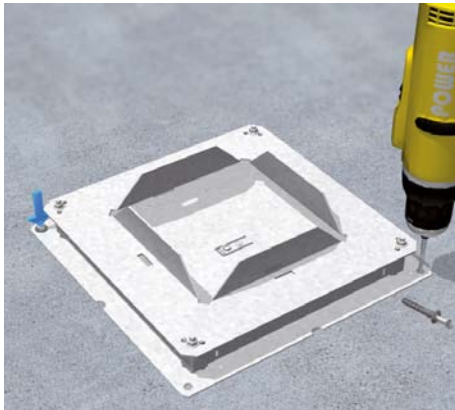

1 | Hollow space floor box
Align floor box in the centre to cable run. Mount with two nail plugs.

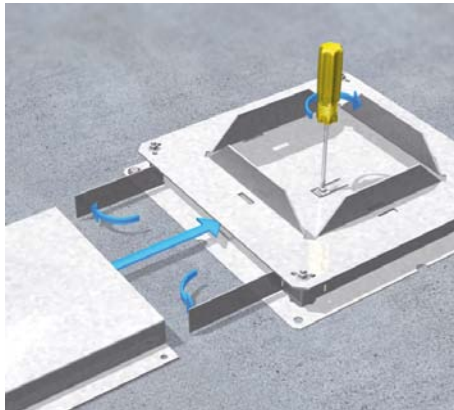

2 | Duct
Screw on earthing lug. Bend the sides of the floor box open along the perforation. Insert duct all the way into the box.

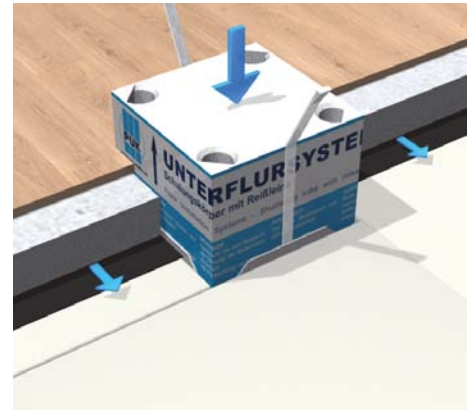

3 | Shuttering unit
Insert the shuttering unit, process screed to the body, remove the shuttering unit after precipitation.

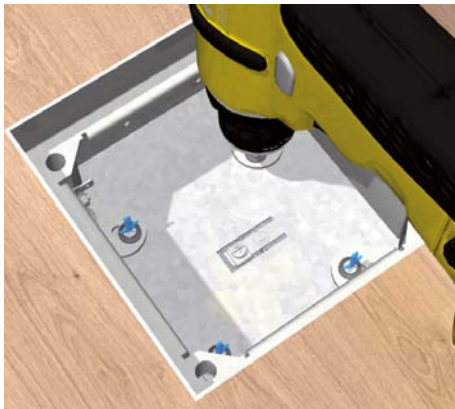

4 | Fixation
Insert the frame and mount the four levelling legs onto the bottom of the hollow floor box with nail plugs.

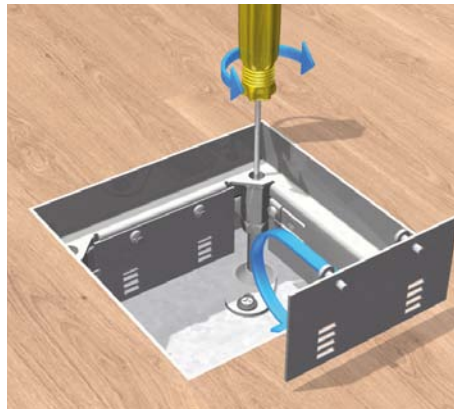

5 | Floor adjustment
Adjust the single outlet succinctly above the four levelling screws. Screw in the lock-in leads.

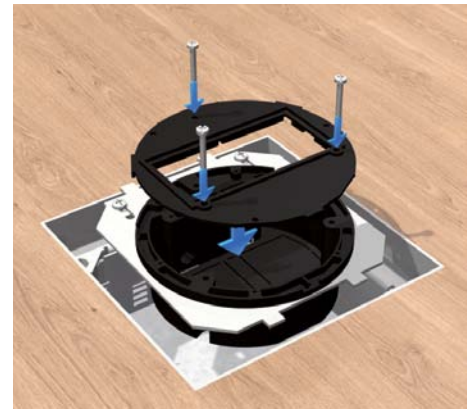

6 | Cover plate
Fix the cover plate onto the device cup with screws.

Single outlet, quadrangular | Hollow space floor box

Assembly instruction

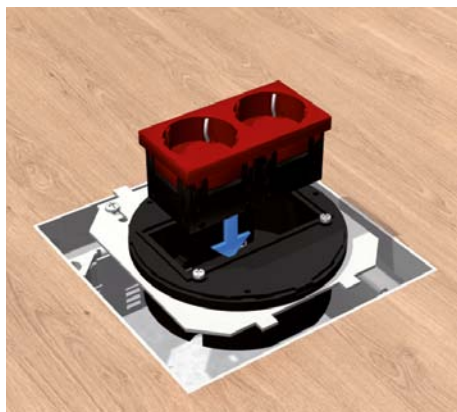

7 | Fixture of installation devices

Latch two installation devices 45 x 45 mm in the cover plate UARM-4-1 118.



8 | Device cup

Place the device cup into the plate, insert the ducts into strain relief and screw in the fixing bolt.

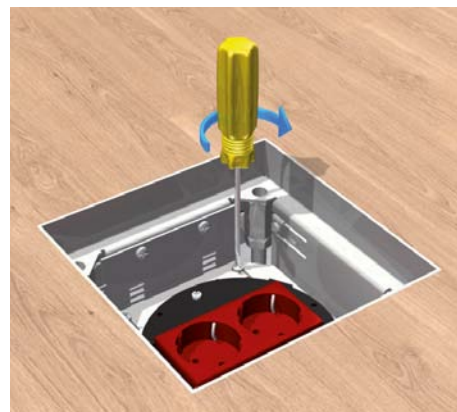

9 | Lock-in lead

Insert the plate above the plate slide as deeply into the lock-in leads as possible. For a stepwise shafting of the plate until up to 20 mm.



10 | Installation of installation devices

Latch one installation device 45 x 45 mm and one installation device 22,5 x 45 mm in cover plate UARM-3-1 118.



11 | Installation of installation devices

Latch two installation devices 22,5 x 45 mm in cover plate UARM-2-1 118.

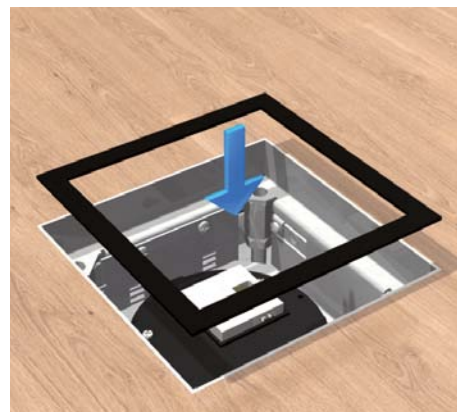

12 | Rubber seal

Glue the rubber seal into the frame.

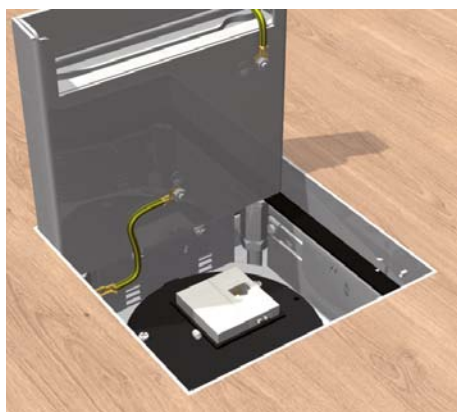

13 | Earthing connection

Establish an earthing connection between the single outlet frame and the cover. Factor the single outlet into the potential equalisation.



14 | Single outlet

Close the cover.

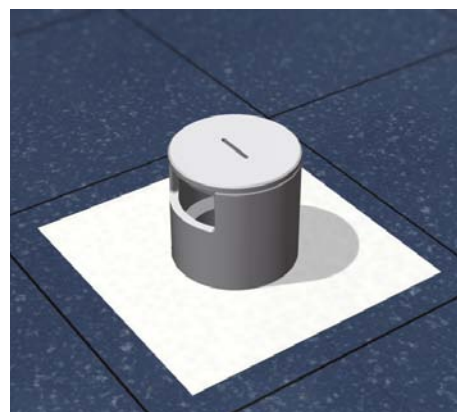

15 | Tube

For wet maintenance floors install tube single outlet and tube.

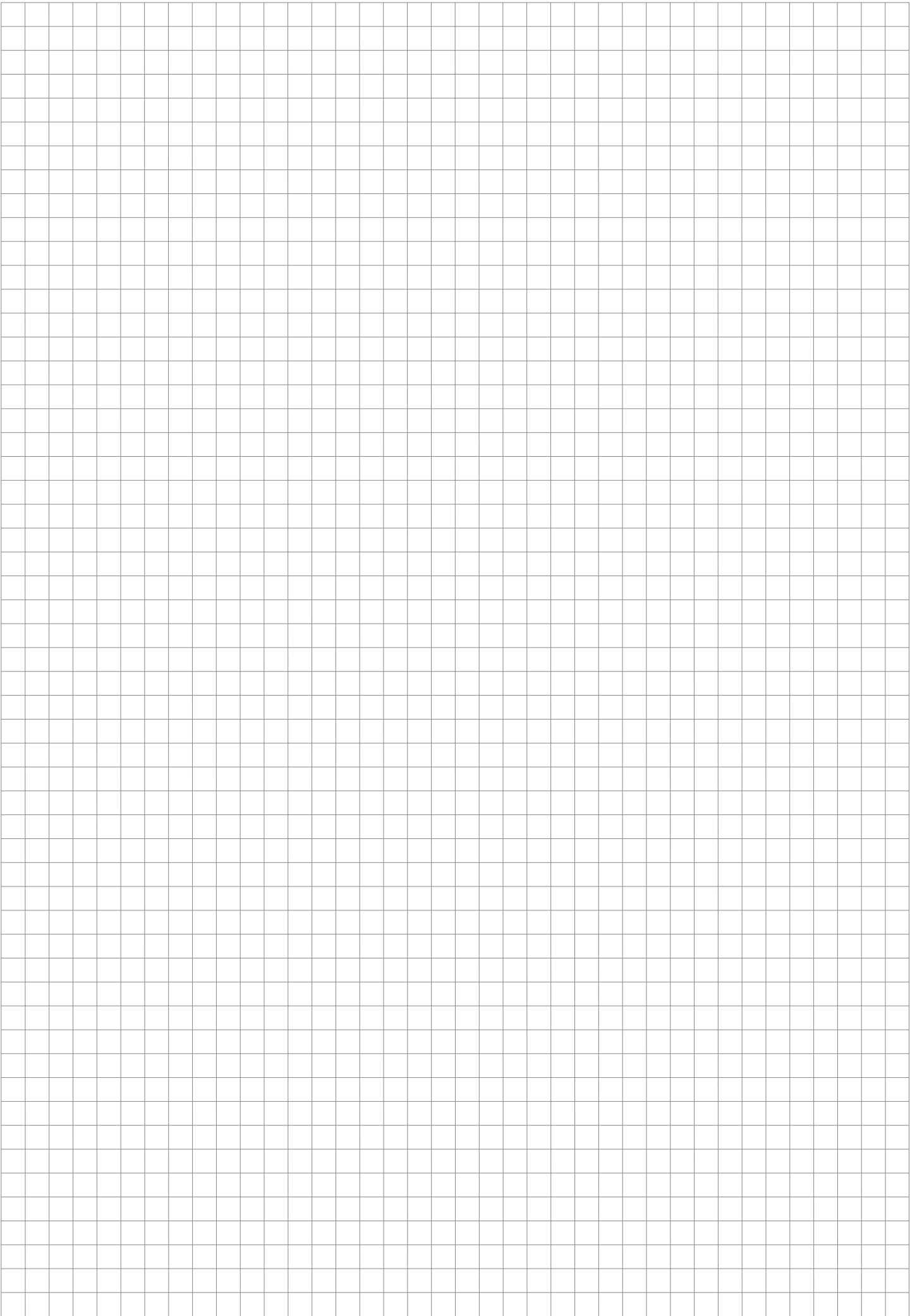



Errors and technical modification subject to change. Reproduction as well as electronic duplication only with our written permission. With appearance of this print all preceding documents lose their validity.

